

PPS GARAGE KITS

ASSEMBLY KITS

TOOLS AND PARTS NOT INCLUDED

DRILL



DRILL BIT



SCREW



GLOVES



TAPE MEASURE



MARKER



* Screw size and washer dependent on mounting surface

WARNINGS



DO NOT DISASSEMBLE THE FITTING
DO NOT PERFORM MAINTENANCE ON THE SYSTEM WHILE IT IS UNDER PRESSURE



ONCE INSTALLATION IS COMPLETE, TEST THE SYSTEM AT LOW PRESSURE

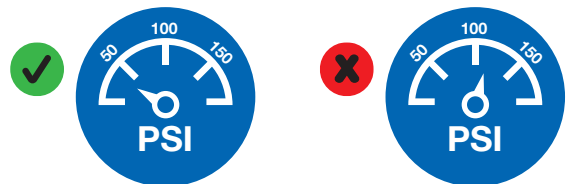

SELECT AN APPROPRIATE COMPRESSOR FOR YOUR SYSTEM SIZE AND APPLICATION

Pressure = 116 PSI
 Max. pressure drop 5% (5.8 psi)
 Max. speed = 32 ft/s

COMPRESSOR*					RECOMMENDED PIPE DIAMETER
POWER		FLOW RATE			
kW	CV	Nm3/h	NI/min	Scfm	
2.2	3	22	367	13	1/2"
3	4	30	500	18	1/2"
4	5.5	40	667	24	3/4"
5.5	7.5	50	834	29	3/4"
7.7	10	70	1167	41	3/4"
11	15	100	1667	59	1"

* Data will vary slightly depending on compressor manufacturers

ASSEMBLY INSTRUCTIONS

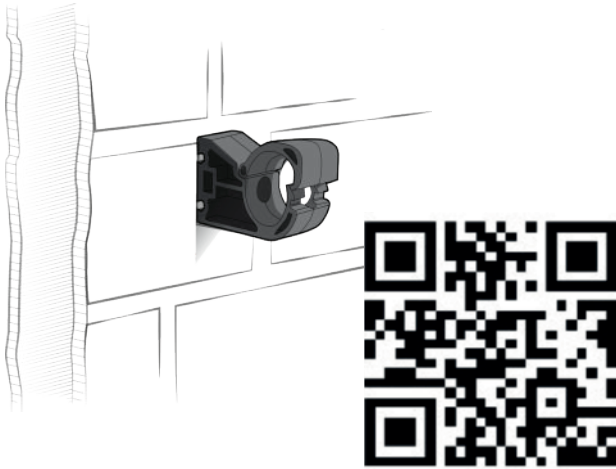

1. Mount pipe clamps to the wall.
Scan the QR code or visit www.youtube.com/@PREVOSTair to view installation videos.

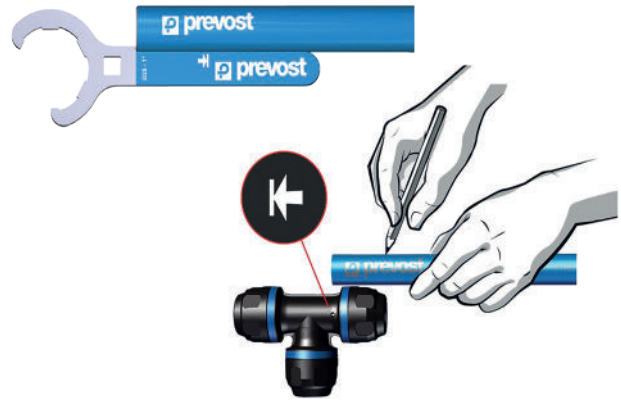

2. Mark the pipe to determine the pipe insertion depth by using the included Prevest wrench.

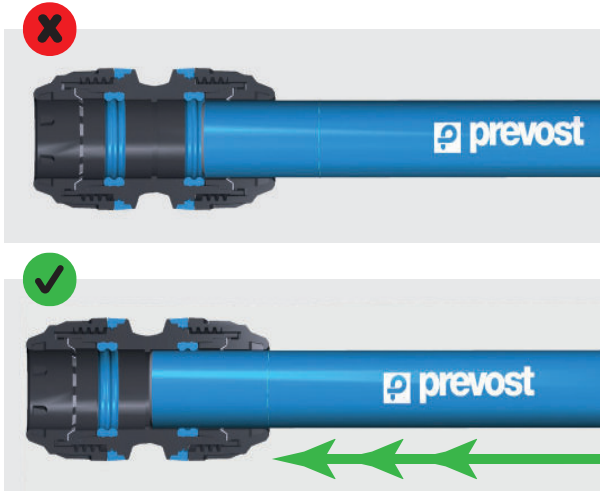

3. Push the pipe into the fitting until it reaches its full insertion depth.



4. Tighten the nuts using the included Prevest wrench.